

Low Voltage (DC)		
Brush motor	Brushless motor	
Miniature screw	Precision screw	Machine screw
2.6 - 8.0 mm		



Delvo Brushless Type

S Series (Variable speed Type) Model DLV30S/45S/70S



Features

- Built-in brushless motor
- Automatic speed control function
- Built-in screw counting function
- Setting with the Remote Controller
- ESD (electrostatic discharge) protection structure

This screwdriver can deal with various fastening conditions.

Torque range **0.4 - 7.0 Nm**
[3.5 - 62.0 lbf-in]

Built-in Automatic Speed Control Function

Low speed starting reduces the problems at start.

<Step 1>

High speed feeding at middle improves efficiency and quality of screw fastening work.

<Step 2>

Low speed fastening at finish reduces the problems at finish.

<Step 3>

Built-in the Functions of Screw Fastening Counter

- screw count setting
- fastening time setting, and fastening time measurement



Main LED mounted on the screwdriver

LEDs and Setting Buttons on the Screwdriver

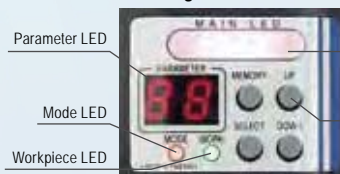

Part Names of the Remote Controller



Specifications

		Low Speed	Standard	High Speed	Low Speed	Standard	Low Speed
Model	Bit	DLV30S06L-AY; K	DLV30S12L-AY; K	DLV30S20L-AY; K	DLV45S06L-AY; K	DLV45S12L-AY; K	DLV70S06L-AY; K
	Lever Start	DLV30S06P-AY; K	DLV30S12P-AY; K	DLV30S20P-AY; K	DLV45S06P-AY; K	DLV45S12P-AY; K	DLV70S06P-AY; K
Power Source		DEA0151N-AZ or DEA0241N-AZ		DEA0241N-AZ	DEA0151N-AZ or DEA0241N-AZ		DEA0241N-AZ
Torque Adjustment		Stepless					
Torque (Nm [lbf-in])	Low Torque Spring ^{*1}	0.4 - 1.6 [3.5 - 14.2]			2.0 - 4.5 [17.7 - 39.8]		3.8 - 7.0 [33.6 - 62.0]
	High Torque Spring ^{*2}	1.2 - 3.0 [10.6 - 26.6]					
Free Speed (min ⁻¹)		For the details, see separate setting range of speed and torque.					
Speed Level		Lv1 - Lv9 (Lv1: Min. Speed Lv9: Max. Speed decreases in a step-by-step manner)					
Power Consumption (W)		44					
Screw Size (mm)	Machine Screw	2.6 - 5.0			4.5 - 6.0		5.0 - 8.0
	Tapping Screw	2.5 - 4.0			4.0 - 5.0		4.5 - 6.0
Mass (g [lbs])		710 [1.57]			860 [1.90] (with pistol grip)		
Standard Accessories ^{*3}		• Bit NK35 × 2 × 7 × 75 • Low Torque Spring • Suspension Bail		• Connection Cord (DLW9073)		• Bit NK35 × 2 × 7 × 75 • Connection Cord (DLW9073) • Suspension Bail • Pistol Grip (DLW2300ESD)	

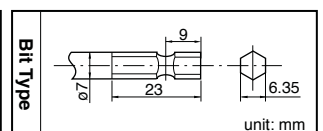

Please contact us for 5 mm bit type

*1: Standard Accessory

*2: Built-in

*3: The power cord is sold separately. Ask us for the required power cord when ordering.

Setting Range of Speed and Torque (for reference only)

		DLV30S06		DLV45S06		DLV70S06				DLV30S12		DLV45S12				DLV30S20			
Speed Level	Speed (min ⁻¹)	Torque (Nm [lbf-in])						Speed Level	Speed (min ⁻¹)	Torque (Nm [lbf-in])						Speed Level	Speed (min ⁻¹)	Torque (Nm [lbf-in])	
Lv1	160	0.4 - 1.3 [3.5 - 11.5]		-		-		Lv1	300	0.4 - 0.6 [3.5 - 5.3]		-		Lv1	500	0.4 [3.5]			
Lv2	220	0.4 - 2.0 [3.5 - 17.7]		2.0 - 2.4 [17.7 - 21.2]		-		Lv2	420	0.4 - 1.2 [3.5 - 10.6]		-		Lv2	690	0.4 - 0.8 [3.5 - 7.0]			
Lv3	280	0.4 - 2.7 [3.5 - 23.9]		2.0 - 3.5 [17.7 - 30.9]		3.8 [33.6]		Lv3	530	0.4 - 1.8 [3.5 - 15.9]		2.0 [17.7]		Lv3	880	0.4 - 1.2 [3.5 - 10.6]			
Lv4	340	0.4 - 3.0 [3.5 - 26.6]		2.0 - 4.5 [17.7 - 39.8]		3.8 - 4.6 [33.6 - 40.7]		Lv4	640	0.4 - 2.4 [3.5 - 21.2]		2.0 - 2.6 [17.7 - 23.0]		Lv4	1,060	0.4 - 1.6 [3.5 - 14.1]			
Lv5	410	0.4 - 3.0 [3.5 - 26.6]		2.0 - 4.5 [17.7 - 39.8]		3.8 - 5.4 [33.6 - 47.8]		Lv5	750	0.4 - 3.0 [3.5 - 26.6]		2.0 - 3.2 [17.7 - 28.3]		Lv5	1,250	0.4 - 2.0 [3.5 - 17.7]			
Lv6	470	0.4 - 3.0 [3.5 - 26.6]		2.0 - 4.5 [17.7 - 39.8]		3.8 - 6.2 [33.6 - 54.9]		Lv6	860	0.4 - 3.0 [3.5 - 26.6]		2.0 - 3.8 [17.7 - 33.6]		Lv6	1,440	0.4 - 2.4 [3.5 - 21.2]			
Lv7	530	0.4 - 3.0 [3.5 - 26.6]		2.0 - 4.5 [17.7 - 39.8]		3.8 - 7.0 [33.6 - 62.0]		Lv7	980	0.4 - 3.0 [3.5 - 26.6]		2.0 - 4.4 [17.7 - 38.9]		Lv7	1,630	0.4 - 2.8 [3.5 - 24.7]			
Lv8	590	0.4 - 3.0 [3.5 - 26.6]		2.0 - 4.5 [17.7 - 39.8]		3.8 - 7.0 [33.6 - 62.0]		Lv8	1,090	0.4 - 3.0 [3.5 - 26.6]		2.0 - 4.5 [17.7 - 39.8]		Lv8	1,810	0.4 - 3.0 [3.5 - 26.6]			
Lv9	650	0.4 - 3.0 [3.5 - 26.6]		2.0 - 4.5 [17.7 - 39.8]		3.8 - 7.0 [33.6 - 62.0]		Lv9	1,200	0.4 - 3.0 [3.5 - 26.6]		2.0 - 4.5 [17.7 - 39.8]		Lv9	2,000	0.4 - 3.0 [3.5 - 26.6]			

*Speed and torque are for reference only. The actual values depend on the materials to be fastened and size of screws. The values are not guaranteed.

Setting Range for Standard Models

The low speed level is effective in hard-to-fasten applications such as tapped holes in sheet metal, stainless steel, and plastic. The high speed level is effective in shortening the cycle time in an assembly line.

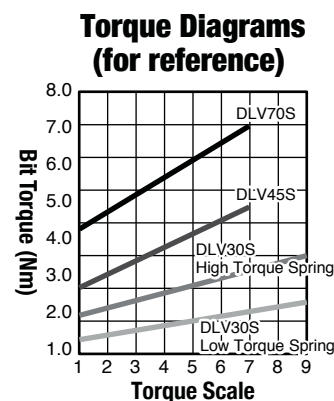
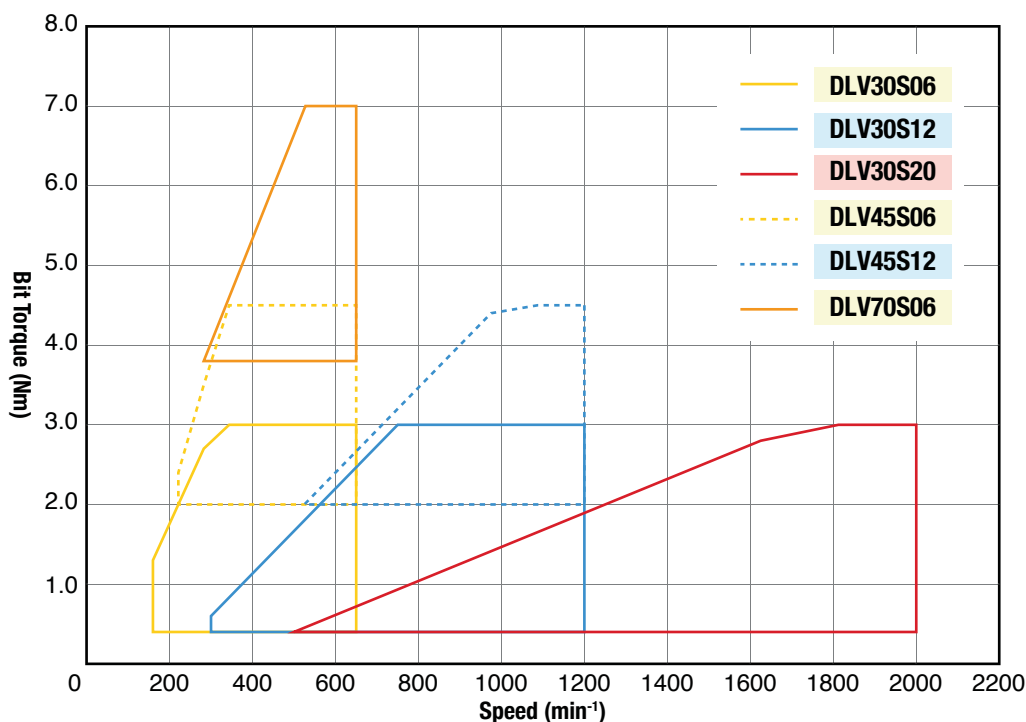

*Graphs are for reference only. The actual values depend on usage conditions.

Equipped with the External Signal Connector

The screwdriver can accept an external signal or output a signal externally through the external signal connector.

Pin No.	Lead wire color	Signal	Input / output
1	Red	+24 V DC power (supplied from outside)	
2	White	Workpiece Signal	Input
3	Green	Reset signal	Input
4	Yellow	LINK-IN	Input
		Forced stop signal	
5	Brown	OK Signal	Output
6	Blue	NG Signal	Output
7	Gray	LINK-OUT	Output
		Channel switching signal	
8	Orange	Torque-up (count) signal	Output
9	Peach	Channel A	Input
10	Purple	Channel B	Input
11	Yellow Green	Channel C	Input
12	Black	0 V DC	

Lead wire colors are the ones used in the optional signal cable ass'y DLW9090.

*Either Pin No.4 or 7 must be selected, but not both.

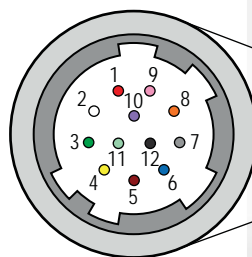

Optional Accessories

Power Supply DEA0151N-AZ DEA0241N-AZ		Grounded 3-Prong Power Cord DLW9220 DLW9240 DLW9250 North America Europe UK			Remote Controller RC1000
• Power cord is not included					
Signal Cable Ass'y DLW9090	Connection Cord DLW9073	Relay Cord (To connect DLW9073 and DLW9073) DLW9074			
*Standard accessory of screwdrivers					

External Dimensions

•DLV30S□P 	•DLV30S□L
•DLV45S□P 	•DLV45S□L
•DEA0151N-AZ 	•RC1000
•DEA0241N-AZ 	

unit: mm [inch]